

EXCEED

Light-emitting diode

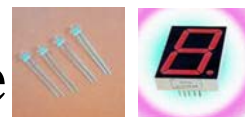

PartNumber: RL81-S3B7G746/I6

Features

- 1.Low power consumption.
- 2.High efficiency.
- 3.Versatile mounting on p.c board or panel.
- 4.I.C compatible/ low current requirement.

Package Dimensions

Unit □ mm

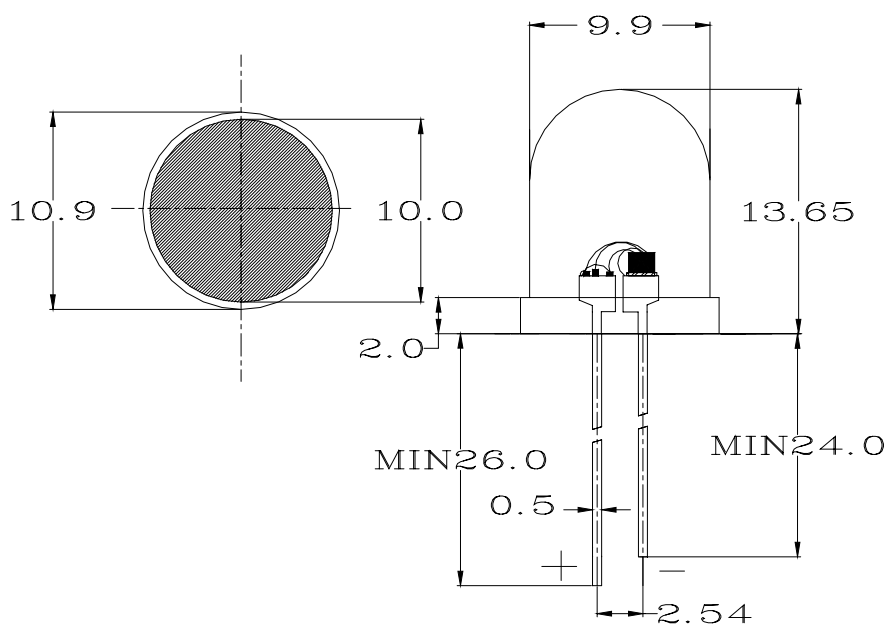

Selectio

NOTE: TOLERANCE ± 0.2 mm

| Part Number | Lens color | Chip | | |
|------------------|-------------|-------------|---------------|------------------|
| | | Material | Emitted color | λ_p (nm) |
| RL81-S3B7G746/I6 | Water Clear | GaAlAs/GaAs | RED | 645 |
| | | InGaN/GaN | BLUE | 465 |
| | | InGaN/GaN | GREEN | 520 |

EXCEED PERSEVERANCE ELECTRONICS IND CO., LTD.

EXCEED

Light-emitting diode



TECHNICAL SPECIFICATION

Part Number: RL81-S3B7G746/I6(RED)

| Parameter | Symbol | MIN. | TYP. | MAX. | UNIT | TEST CONDITION |
|---------------------------|-------------|------|------|------|---------|----------------|
| Forward Voltage | VF | 4.0 | 4.5 | 5.0 | V | If=20mA |
| Peak Wavelength | λ_p | 640 | 645 | 650 | nm | |
| Reverse Current | IR | | | 100 | μ A | VR=5V |
| Power dissipation | Pd | | 110 | | mW | |
| Luminous Intensity | IV | 800 | 1000 | | mcd | If=20mA |
| Peak Forward Current | If(Peak) | | | 20 | mA | |
| Recommend Forward Current | If(Rec) | | 30 | | mA | |
| Blinking frequency | Fblk | | 2.4 | | HZ | VDD=5V |

NOTE:

1.Luminous intensity is measured with a light sensor and fillister combination that approximates the CIE eye-response curve Tester: EG&G DR-2550.

2.IV classification code is marked on each packing bag. The IV base on line-on's bin classification. The IV guarantee should be add $\pm 15\%$

3.Absolute maximum ratings: (Ta=25 \square)

4.Operating temperature : -40 \square TO 80 \square

5.Lead soldering: 260 \square for 5 seconds

EXCEED

Light-emitting diode



TECHNICAL SPECIFICATION

Part Number: RL81-S3B7G746/I6(BLUE)

| Parameter | Symbol | MIN. | TYP. | MAX. | UNIT | TEST CONDITION |
|---------------------------|-------------|------|------|------|---------|----------------|
| Forward Voltage | VF | 4.0 | 4.5 | 5.0 | V | If=20mA |
| Peak Wavelength | λ_p | 460 | 465 | 470 | nm | |
| Reverse Current | IR | | | 100 | μ A | VR=5V |
| Power dissipation | Pd | | 170 | | mW | |
| Luminous Intensity | IV | 2200 | 2650 | | mcd | If=20mA |
| Peak Forward Current | If(Peak) | | | 100 | mA | |
| Recommend Forward Current | If(Rec) | | 30 | | mA | |
| Blinking frequency | Fblk | | 2.4 | | HZ | VDD=5V |

NOTE:

1.Luminous intensity is measured with a light sensor and fillister combination that approximates the CIE eye-response curve Tester: EG&G DR-2550.

2.IV classification code is marked on each packing bag. The IV base on line-on's bin classification. The IV guarantee should be add $\pm 15\%$

3.Absolute maximum ratings: (Ta=25 \square)

4.Operating temperature : -40 \square TO 80 \square

5.Lead soldering: 260 \square for 5 seconds

EXCEED

Light-emitting diode



TECHNICAL SPECIFICATION

Part Number: RL81-S3B7G746/I6(PURE GREEN)

| Parameter | Symbol | MIN. | TYP. | MAX. | UNIT | TEST CONDITION |
|---------------------------|-------------|------|------|------|---------|----------------|
| Forward Voltage | VF | 4.0 | 4.5 | 5.0 | V | If=20mA |
| Peak Wavelength | λ_p | 515 | 520 | 525 | nm | |
| Reverse Current | IR | | | 100 | μ A | VR=5V |
| Power dissipation | Pd | | 170 | | mW | |
| Luminous Intensity | IV | 2200 | 2650 | | mcd | If=20mA |
| Peak Forward Current | If(Peak) | | | 100 | mA | |
| Recommend Forward Current | If(Rec) | | 30 | | mA | |
| Blinking frequency | Fblk | | 2.4 | | HZ | VDD=5V |

NOTE:

1.Luminous intensity is measured with a light sensor and fillister combination that approximates the CIE eye-response curve Tester: EG&G DR-2550.

2.IV classification code is marked on each packing bag. The IV base on line-on's bin classification. The IV guarantee should be add $\pm 15\%$

3.Absolute maximum ratings: (Ta=25 \square)

4.Operating temperature : -40 \square TO 80 \square

5.Lead soldering: 260 \square for 5 seconds